

CB

Floor Bumper

The CB is a floor mounted bumper rail that protects fixtures, cases, walls and windows from impact damage in grocery stores, retail stores, hospitals and warehouses. Alvarado's CB is also often used to provide a stop for shopping carts in cart corrals.

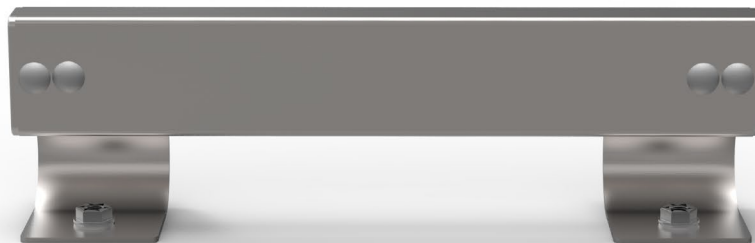

Fixture Protection



Grocery Stores

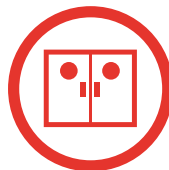

Store Backroom



Club Stores



Retail Stores



CB Floor Bumper

Alvarado’s heavy-duty CB floor bumper uses anchoring feet made from specially engineered spring steel, which flexes to absorb the force of an impact. The CB is often used as a cart stop in cart corrals, in areas where pallets are placed and removed, or to protect store windows.

Product Features

- Heavy duty impact protection
- Join individual sections to create seamless runs
- Feet made from engineered spring steel

Compact Design

The CB can be installed close to walls and fixtures, minimizing trip hazards.

Complementary Products

DM and CRI corner guards are a highly effective method of preventing damage to expensive store fixtures and equipment.



Material and Finish

- 11-gauge steel U-channel
- 7-gauge spring steel feet
- Chrome (indoor) or galvanized (indoor / outdoor) finishes

Available Lengths

The CB is available in individual sections from 2’ to 6’. Each 2’ to 6’ section comes with two spring steel feet. Additional sections and additional feet are added to create longer runs along walls, cases, and around corners.



Dimensions

Measurements in inches (mm)

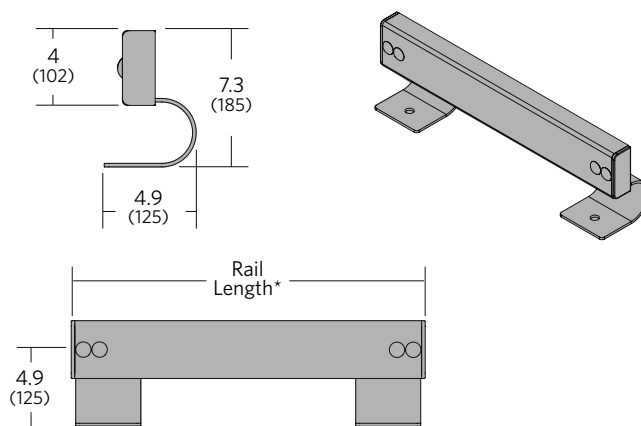

Join sections to create long runs



135° Corner

*Available rail lengths in feet (mm)

- | | | | | |
|-------------|-------------|--------------|--------------|--------------|
| 2' (610 mm) | 3' (914 mm) | 4' (1219 mm) | 5' (1524 mm) | 6' (1829 mm) |
|-------------|-------------|--------------|--------------|--------------|